

# Multi-Door Household Refrigerator

## Operating Instructions

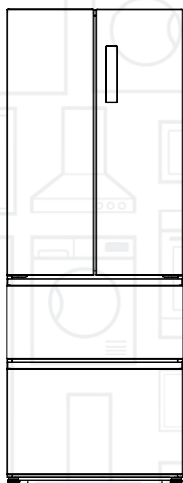

■ Please carefully read the operation instructions before power on, and keep them handy.

■ The products may subject to changes without notice.

**MN13790PX**

**EN**

**beko**



## **Please read these instructions first before using your appliance**

Thank you for choosing a Beko appliance.

Please take some time to read this user manual before using your appliance, to ensure you know how to safely operate the controls and functions.

Carefully follow all unpacking and installation instructions to ensure the appliance is correctly connected and fitted prior to use.

Please write your product model and serial number on the last page of this user manual, and store in a safe location close to the appliance for easy future reference.

This user manual may also be applicable for several other models. Differences between models will be listed.

If you have any questions or concerns, please call our contact centre or find help and information online at [www.beko.co.uk](http://www.beko.co.uk)

## Contents

Thank you for buying the refrigerator. We hereby express our thanks.

Welcome to use the refrigerator. We will do our best to provide you with quality service.

|  |     |
|--|-----|
| Safety instructions .....                          | P2  |
| Product introduction .....                         | P5  |
| Handling and placement .....                       | P6  |
| Preparations prior to use .....                    | P7  |
| Operation notes .....                              | P8  |
| Illustration and operation of display panel .....  | P8  |
| Food storage .....                                 | P11 |
| Ice-making .....                                   | P11 |
| Guidance for storing fresh food .....              | P12 |
| Guidance for using the freezer .....               | P13 |
| Disassembly and assembly method of accessory ..... | P14 |
| Maintenance .....                                  | P14 |
| Failure analysis .....                             | P15 |
| Non-failure .....                                  | P15 |
| Technical parameter .....                          | P16 |
| Packing list .....                                 | P16 |

1. This appliance is not intended for use by persons (including children) with reduced physical, sensory or mental capabilities, or lack of experience and knowledge, unless they have been given supervision or instruction concerning use of the appliance by a person responsible for their safety. Children should be supervised to ensure that they do not play with the appliance.

2. If the supply cord is damaged, it must be replaced by the manufacturer, its service agent or similarly qualified persons in order to avoid a hazard.

3. This appliance can be used by children aged from 8 years and above and persons with reduced physical, sensory or mental capabilities or lack of experience and knowledge if they have been given supervision or instruction concerning use of the appliance in a safe way and understand the hazards involved. Children shall not play with the appliance. Cleaning and user maintenance shall not be made by children without supervision.

4. **WARNING:** Keep ventilation openings, in the appliance enclosure or in the built-in structure, clear of obstruction.

5. **WARNING:** Do not use mechanical devices or other means to accelerate the defrosting process, other than those recommended by the manufacturer.

6. **WARNING:** Do not damage the refrigerant circuit.

7. **WARNING:** Do not use electrical appliances inside the food storage compartments of the appliance, unless they are of the type recommended by the manufacturer.

8. Do not store explosive substances such as aerosol cans with a flammable propellant in this appliance.

9. This appliance is intended to be used in household and similar applications.

10. This product contains a light source of energy efficiency class F for light source ERP, test with (without) light cover.

## **1.Warning**

**Warning:** No barrier is allowed around the appliance or in the embedded structure in order to ensure the free ventilation.

**Warning:** It is forbidden to speed up the defrosting process with any mechanical equipment or by other method except for the method recommended by the manufacturer.

**Warning:** Never damage the refrigerating circuit.

**Warning:** Never use any electric apparatus in the food chamber of the appliance except for the type recommended by the manufacturer.

**Warning:** Never place the liquid beverage or food contained with glass container in the freezing chamber for fear of cracking.

**Warning:** If powered off, the refrigerator should not be powered on again until at least 5 minutes for fear of damaging the compressor.

**Warning:** If any live part, abnormal noise, smell, smoke or other abnormality is found during use, it is necessary to power off the appliance immediately and contact the after-sales service department of the Company timely.

**Warning:** Never place your finger or hand under the refrigerator, especially rear bottom of refrigerator; otherwise, you may be hurt by the sharp matter.

**Warning:** The children must not play or climb the refrigerator. The operation by the children must be supervised by their parents for fear of danger.

**Warning:** Never place your hand between the doors to open or close door for fear of jamming your finger. The door handle shall be used to open or close the door.

**Warning:** Under the rated climate types SN, N and ST, the operating ambient range of the appliance is 10°C~38°C; under the climate types SN, N, ST and T, the operating ambient range of the appliance is 10°C~43°C. If the appliance operates outside the rated climate type (ambient temperature range), the appliance may not maintain the satisfying interior temperature.



**Warning:** Risk of fire / flammable materials

**Warning:** When positioning the appliance, ensure the supply cord is not trapped or damaged.

**Warning:** Do not locate multiple portable socket-outlets or portable power supplies at the rear of the appliance.

Children aged from 3 to 8 years are allowed to load and unload refrigerating appliances

Opening the door for long periods can cause a significant increase of the temperature in the compartments of the appliance.

Clean regularly surfaces that can come in contact with food and accessible drainage systems.

Clean water tanks if they have not been used for 48 h; flush the water system connected to a water supply if water has not been drawn for 5 days.

Store raw meat and fish in suitable containers in the refrigerator, so that it is not in contact with or drip onto other food.

Two-star frozen-food compartments are suitable for storing pre-frozen food, storing or making ice-cream and making ice cubes.

One-, two- and three-star compartments are not suitable for the freezing of fresh food.

If the refrigerating appliance is left empty for long periods, switch off, defrost, clean, dry, and leave the door open to prevent mould developing within the appliance.

## 2. Cautions

**Cautions:** The power supply of this product must be uniform with the power supply mentioned on the nameplate, and the standard independent 3-hole socket shall be used (above 10A, and reliably grounded). One socket must not be shared by more than one appliance; otherwise, fire may be caused due to overheat.

**Cautions:** Never pull the power wire by hand. It is necessary to hold and unplug the power connector from the socket to disconnect the power supply. The power wire or connector must not be touched by the wet hand for fear of electric shock.

**Cautions:** The power wire must not be squeezed by the refrigerator or any heavy load, and the power wire shall not be bent extremely. The damage or peeling of power wire may result in fire or electric shock. If the power wire is broken or cut, please contact the after-sales service department immediately.

**Cautions:** No flammable or explosive matter or corrosive acid or alkaline matter is allowed in the refrigerator.

**Cautions:** The refrigerator must not be used outdoors.

**Cautions:** It is forbidden to place the container with fluid on the refrigerator because the breakage or turnover of the container may affect the electrical insulation of refrigerator and result in electric shock or fire.

**Cautions:** The refrigerator must not be disassembled or modified without permission. The repair of refrigerator must be performed by the specialist.

**Cautions:** In case of leakage of any flammable gas, it is necessary to close the leaking valve first and then open the window for ventilation, and forbidden to unplug the refrigerator connector immediately for fear of fire or explosion due to electric spark.

**Cautions:** Refrigerating appliances – in particular a refrigerator-freezer Type I – might not operate consistently (possibility of defrosting of contents or temperature becoming too warm in the frozen food compartment) when sited for an extended period of time below the cold end of the range of temperatures for which the refrigerating appliance is designed;

**Cautions:** The need to not exceed the storage time(s) recommended by the food manufacturers for any kind of food.

**Cautions:** The precautions necessary to prevent an undue rise in the temperature of the frozen food while defrosting the refrigerating appliance, such as wrapping the frozen food in several layers of newspaper.

**Cautions:** The fact that a rise in temperature of the frozen food during manual defrosting, maintenance or cleaning could shorten the storage life.

**Cautions:** The care required with regard to frozen food in storage in the event of an extended non-running of the refrigerating appliance (interruption of power supply or failure of the refrigerating system).

**Cautions:** The action to be taken when the refrigerating appliance is switched off and taken out of service temporarily or for an extended period (e.g. emptied, cleaned and dried, and the door(s) or lid(s) propped ajar).

## Product introduction

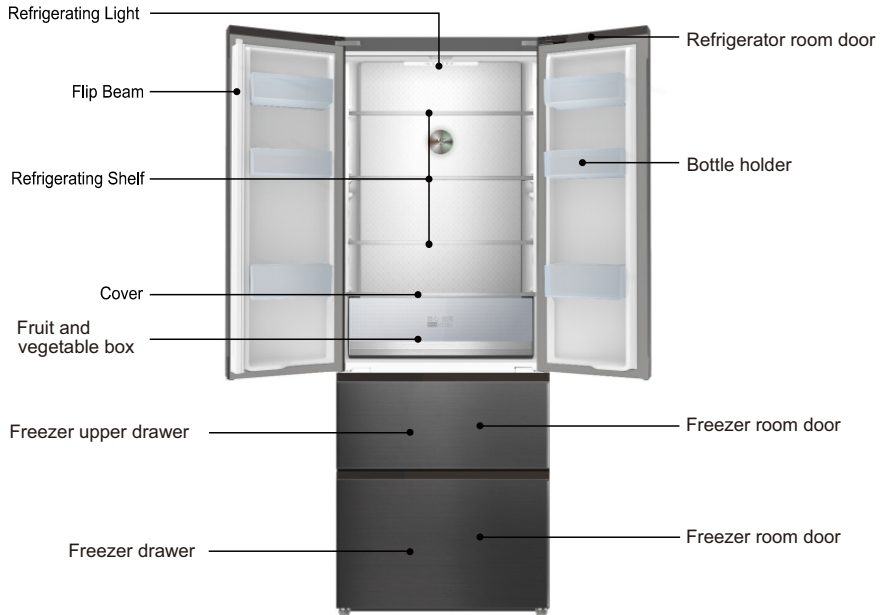

The pictures are for reference only. Please refer to the object

### Features

- Computer intelligent temperature control ; air cooling and frost free.
- Environmental-friendly refrigerant, It applies materials without CFC, R600a environmental-friendly materials. 80% of the main materials can be recycled;
- Transparent drawers with novel appearances and their internal foods can be clear at a glance;
- The tempered glass refrigeration shelves are height adjustable, wear proof, heat-proof and practical;
- The concealed condenser applies flat back design. It has perfect and coordinated style which is simple, easy to clean and high utility rate of space;
- This product adopts the efficient mute compressor of international brand and special case foaming technology, and features low noise, low energy consumption, and is more suitable for family than commercial purposes.

### Warm prompt:

Your product may differ from the illustrations and text of other products also covered by this User Manual



## Handling and placement

Certain space shall be left around the refrigerator, shown in the figure.

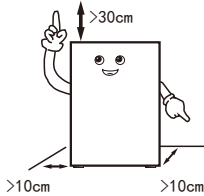

During handling, the door side of the refrigerator shall not contact with the handling tools

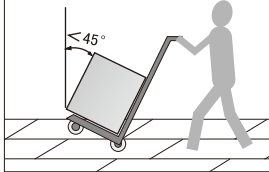

The refrigerator shall be placed in an environment which is dry, has good ventilation, far from direct sunshine and heat source.

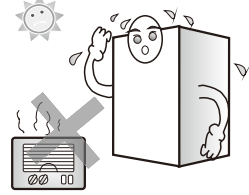

The refrigerator shall be placed on the flat and firm surface. If the ground is not flat, adjust the adjusting leg to keep it level.

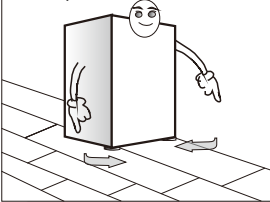

Never place the refrigerator into a too cold environment that may get frozen.

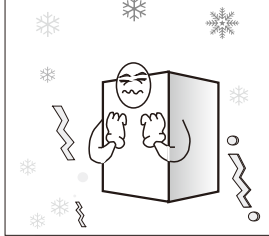

Removing the foam base is beneficial for bottom heat dissipation and can avoid fire.

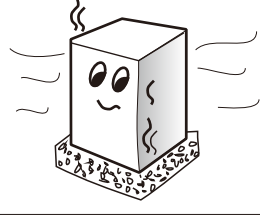

### Caution:

When handling the refrigerator, at least two persons are required – one lifts the top of rear part, the other one handles the bottom (if one part is clamped, it is quite heavy and may cause accident).

—When moving the refrigerator, the lower runner may damage and scratch the floor. If you need to move the refrigerator for a long distance, the internal accessories shall be fixed using adhesive tape. Otherwise, the accessories may get damaged due to crashing each other.

—Please place the refrigerator in the position with small vibration or little exposed to vibration. For users in the area where earthquake often occurs, please fix the refrigerator against the wall or pole. Otherwise, the falling of refrigerator will cause accident.

—Sufficient clearance shall be left around. If the clearance is too small or goods on the top or close to the side, or on the sides, the heat dissipation of refrigerator will be affected, and

thus to cause unnecessary electric energy waste as well as burn out of the wall and other goods; the contact between the back and wall will cause vibration and noise;

—Adjust the front part and adjusting leg of the refrigerator to level it. Unlevelling of the refrigerator will cause vibration and noise.

## Handling and placement

The outline dimension of the product and the space needed by the use of product are shown in the following pictures:

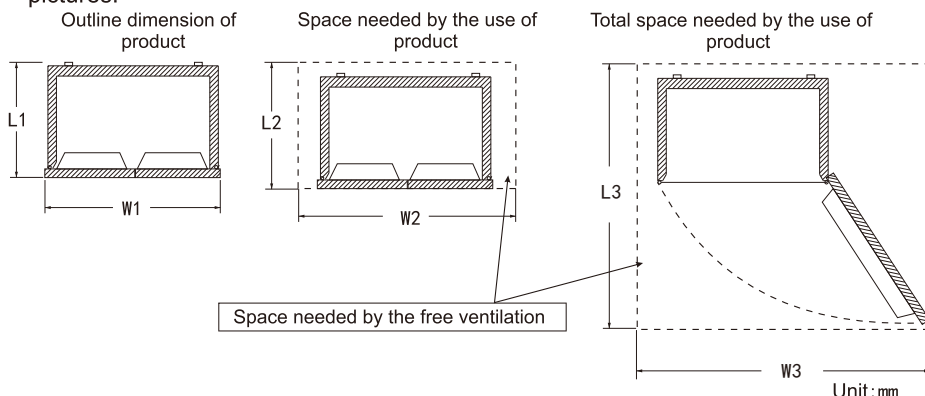

| Product model | Outline dimension of product |     | Space needed by the use of product |           | Total space needed by the use of product |           |
|---------------|------------------------------|-----|------------------------------------|-----------|--|-----------|
|               | L1                           | W1  | L2                                 | W2        | L3                                       | W3        |
| MN13790PX     | 677                          | 703 | $>L1+100$                          | $>W1+200$ | $>L1+300$                                | $>W1+500$ |

## Preparations prior to use

1. Remove all packing assemblies such as case fixing tape etc., especially the foam base.
2. Use warm wet cloth to clean both interior and exterior of the refrigerator, (neutral detergent can be added in warm water).
3. After leveling and cleaning the refrigerator, stand it for about 5 hours before plugging the power plug for powering on, and cool the refrigerator for 2 to 3 hours before storing foods.

### 1. Remove fixing tape

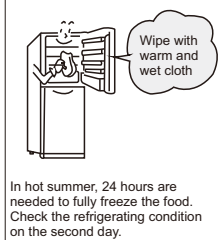

### 2. Connect to power



### 3. Store food after connecting to power for 2-3 hours

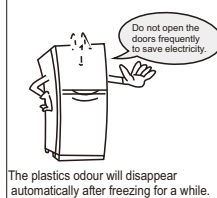

The appliance should be located in the coolest area of the room, away from heat producing appliances or heating ducts, and out of the direct sunlight.

Let hot foods cool to room temperature before placing in the appliance. Overloading the appliance forces the compressor to run longer. Foods that freeze too slowly may lose quality, or spoil.

Be sure to wrap foods properly, and wipe containers dry before placing them in the appliance. This cuts down on frost build-up inside the appliance.

Appliance storage bin should not be lined with aluminum foil, wax paper, or paper toweling. Liners interfere with cold air circulation, making the appliance less efficient.

Organize and label food to reduce door openings and extended searches. Remove as many items as needed at one time, and close the door as soon as possible.

## Operation notes

### Operation and diagram of display board

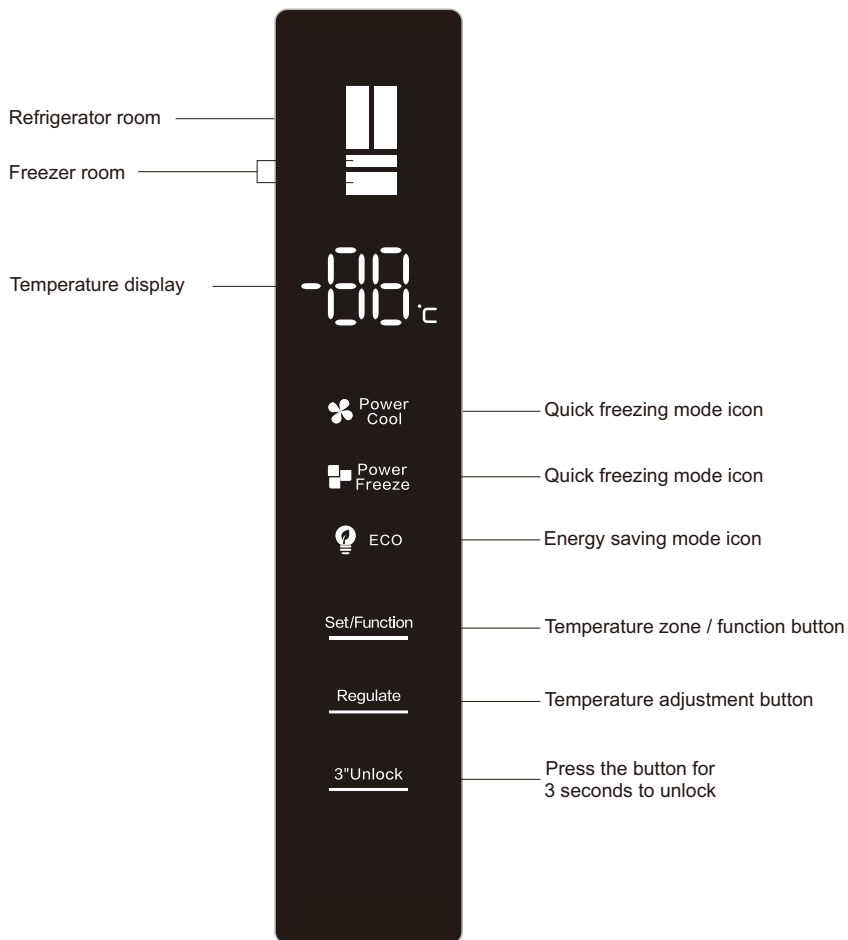

The above is the computer control board of the product

### **Power on for the first time**

The first time the power is turned on, the refrigerator operates according to the refrigerator room at 5 ° C, and in the freezer at -18 ° C.

### **Child lock function**

On: When there is no key operation in the display within 30 seconds, the child lock icon on the display lights up, and the remaining characters go out, and the child lock function is entered immediately. After 5 minutes, the child lock icon goes out and enters the display protection function. In the screen saver mode, Press any key to exit the screen saver mode.

Close: When the child lock of the display is turned on, press and hold the "Unlock for 3 seconds" button for 3 seconds to unlock, that is, the child lock function is turned off.

### **Refrigerator temperature adjustment**

In the unlocked state, press the "Temperature Zone / Function" button repeatedly until the refrigeration temperature zone lights up, and then press the "Temperature Adjustment" button to refrigerate the room temperature Degree adjustment. The shift of refrigerator compartment stalls recycles around "08"- "07"- "06"- "05"- "04"- "03"- "02"- "OF"- "08". Select the appropriate temperature to stop the key operation and wait for 5 seconds, then set the temperature to confirm.

"Of" means the product is turned off so there is no cooling.

### **Freezer temperature adjustment**

In the unlocked state, repeatedly press the "temperature zone / function" key until the freezing temperature zone lights up, and then press the "temperature adjustment" button to freeze the room temperature The temperature is adjusted. The set temperature of the freezer is "-15"- "-16"- "-17"- "-18"- "-19"- "-20"- "-21 "- "-22 "- "-23 "- "-24 "- "-15 ". Choose the right temperature to stop the key operation and wait 5 seconds, the set temperature is confirmed.

### **Quick cooling function**

In the unlocked state, repeatedly press the "temperature zone / function" button until the "quick cooling" icon flashes, stop the button operation and wait for 5 seconds, Then enter the quick cooling function of the refrigerator. The same operation can exit the quick cooling function. After entering the "quick cooling" 2 hours, it will automatically exit.

In the "quick cooling" state, the set temperature of the refrigerator compartment is displayed as 2 °C until the function is exited. In the "quick cooling" state, when other functions are set, the quick cooling function may be automatically exited. In the "quick cooling" state, the refrigerator The door will automatically exit the quick cooling function after being opened for more than 3 minutes.

### **Quick freeze function**

In the unlocked state, press the "Temperature Zone / Function" button repeatedly until the "Quick Freeze" icon flashes. Stop the key operation and wait for 5 seconds to enter the quick freeze function of the freezer. The same operation can exit the quick freeze function. After entering the "Quick Freeze" After 4 hours of entering the cold state, it will automatically exit.

In the "Quick Freeze" state, the setting value of the freezer is displayed at -32 °C until the function is exited.

In the "Quick Freeze" state, when other function settings are made, the quick freeze function may be automatically exited. In the "Quick Freeze" state, the freezer door is opened for more than 3 minutes Automatically exit the quick freeze function.

### **Energy saving function**

In the unlocked state, repeatedly press the "temperature zone / function" key until the "energy saving" icon flashes, stop the key operation and wait for 5 seconds, Then enter the "energy saving" function. The same operation can exit the energy saving function. After the "energy saving" function is turned on for 10 seconds, the display The remaining characters are automatically extinguished, after which the refrigerator automatically enters a low energy consumption state.

### **Power-off memory**

When the power is cut off, the instantaneous working state at blackout will be locked and resume the state after power on.

## Operation notes

### Door alarm

When the refrigerator or freezer door is not well closed or open for over 1 minute, the buzzer siren will send off sound. Press down any key to stop alarming and the siren sounds "beep, beep, beep" again after 1 minute; close refrigerator or freezer door to stop alarming.

### Freezer compartment temperature reminder

When the temperature of freezer compartment is higher than  $-12^{\circ}\text{C}$ , the corresponding temperature area is lit, the digital area flashes. Press down any key to display temperature of freezer compartment when the power is on, press again or wait for 10 seconds to restore normal display state.

### Display protection function

The refrigerator will enter display protection function without any key operation for 30 seconds, and the key board is locked automatically. Under display protection mode, press any key to exit display protection function.

## Operation keys

### Foods storage

#### Refrigerating chamber ( $2^{\circ}\text{C}\sim 8^{\circ}\text{C}$ )

--The refrigerating chamber is mainly used for storing short-term foods, like milk, eggs and bottled drink.

--Vegetables, melons and fruits shall be put into the fruit and vegetable box to prevent water loss.

--The cooked foods shall be put into the refrigerator after packaging with the preservative bags, to prevent the back from frosting and the power from increasing.

#### Freezing chamber ( $-22^{\circ}\text{C}\sim -15^{\circ}\text{C}$ )

--The freezing chamber is used for the foods to be stored for long-term.

--Fish and meat to be frozen shall be cut into small pieces, packaged with preservative bags separately and then put into the frozen drawer.

--The glass container or the sealed container filled with liquid shall not be stored in the freezing chamber, to prevent the risk of burst due to freezing.

--The fresh foods shall not be stored together with the frozen foods.

--Do not place food close to inside wall in freezer lest food and wall should be frozen together.

#### ★★ Warm tips:

The stored food, if any, shall not block the air duct outlet and return port for fear of affecting the refrigerating effect.

Before being stored in the refrigerator, the overheated water and food shall be cooled to the room temperature.

All accessories, such as drawers, shelves balconies, should be kept there for lower energy consumption.

### Ice-making (If the appliance has it)

Fill the ice-making box with 4/5 water and put the box into the freezing chamber. After the water in the box turns into ice, twist the box slightly to separate the ice from the box. However, don't bend the box. When separating the ice, wrap the box with dry cloth to avoid finger frostbite.

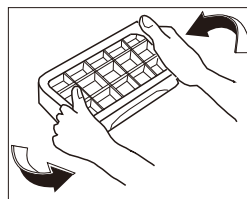

### **Storing into the fresh food compartment:**

- Keep your fridge at recommended temperature level as 4°C.
- Food to be stored should be properly sealed to avoid odour or taste alterations.
- Do not store excessive quantities of food inside your refrigerator. Leave spaces between foods to allow cold air flowing around them to achieve a better and more homogeneous cooling.
- To allow shorter door openings, foods eaten daily should be stored at the front of the shelf.
- Leave a gap between foods and the inner walls, allowing air to flow. If you store foods against the rear wall foods could freeze against rear wall.
- Hot, cooked food must be cooled down at room temperature before storing in the appliance. Then, warm food can be stored in the lower shelves of your fridge. Please do not put warm food nearby highly perishable foods.
- Thaw your frozen food in the fresh food compartment. This way, you can use the frozen food to cool down the fresh food compartment and save energy.
- If unripe tropical fruits (mango, melons, papaya, banana, pineapple) are stored in refrigerator, ageing process can be accelerated and it is not advisable since it causes shorter storage times. However, the ripening of strongly green fruits (apple, pear) can be promoted for a certain period in fridge compartment.
- Onions, garlic, ginger and other root vegetables should be stored at dark and cool room conditions, not in the fridge.
- When a spoiled food inside refrigerator is realized, it should be disposed. When rotten food is noticed, please clean inner liner or accessories which were in contact to prevent contamination.
- Large pots of food, such as soups or stews can be divided into shallow containers to quickly cool in the refrigerator. Large pieces of cooked meat and whole poultry should be divided into smaller pieces for the same purpose.
- Do not store unpacked foods nearby eggs.
- Keep fruits and vegetables separate and store like with like: apples with apples, carrots with carrots. Fruits and vegetables give off different gases that can cause others to deteriorate.
- Take leafy greens out of plastic bags, wrap them in a paper towel or tea towel before stored in refrigerator. Do not forget to dry them if they are rinsed or wet before storing.
- Store fruits and vegetables susceptible to drying out in perforated or unsealed plastic bags to maintain a moist environment yet still allow air to circulate.
- Different foods should be placed in different areas according to their properties:

“Please check appropriate Climate Class of your appliance rated on the rating plate. One of below information is valid for your appliance according to rated Climate Class.”

- SN: Extended Temperate: This refrigerating appliance is intended to be used at ambient temperatures ranging from 10°C to 32°C
- N: Temperate: This refrigerating appliance is intended to be used at ambient temperatures ranging from 16°C to 32°C
- ST: Subtropical: This refrigerating appliance is intended to be used at ambient temperatures ranging from 16°C to 38°C
- T: Tropical: This refrigerating appliance is intended to be used at ambient temperatures ranging from 16°C to 43°C

| <b>Food</b>   | <b>Location</b>   |
|---|---|
| Eggs  | Door rack   |
| Dairy products (butter, cheese)                                       | If available, biofresh or chiller compartment<br>Lowest shelves           |
| Fruits, vegetables and salad  | Fruit and vegetable box, crisper or EverFresh+ compartment (if available) |
| Fresh meat, poultry, fresh fish, sausages, cooked foods               | If available, biofresh or chiller compartment<br>Lowest shelf             |
| Ready to eat foods, packaged products, canned foods, pickled products | Upper shelves or door rack  |
| Drinks, bottles, condiments, snacks                                   | Door rack   |
| Leftovers   | Middle shelves  |

### **Storing into the freezer compartment:**

- It is recommended to keep freezer setting at -20°C except extreme ambient conditions.
- 4-6 hours before freezing switch on the Fast Freeze function to provide faster freezing.
- Hot food must be cooled to room temperature before storing in the freezer compartment.
- Food cut into small portions will freeze faster and be easier to defrost and cook.
- It is better to pack food before putting it into the freezer.
- In order to avoid expiry of storage periods, please note the freezing date, time limit and name of the food on the packaging according to the storage periods of different foods.
- Do not exceed the food storage times recommended by the food manufacturers. Only take the required amount of food out of the freezer.
- Consume defrosted food quickly. Defrosted food cannot be re-frozen unless it is cooked. It is not safe to consume uncooked re-frozen fresh food.
- When freezing fresh food, avoid bringing it in contact with already frozen food. It may cause thawing of already frozen pieces.

### **When storing commercially frozen foods, please follow these guidelines:**

Always follow manufacturers' guidelines for the length of time you should store the food for. Do not exceed these guidelines!

- Try to keep the length of time between purchase and storage as short as possible to preserve food quality.
- Buy frozen foods, which have been stored at a temperature of -18 °C or below.
- Avoid buying food which has ice or frost on the packaging – This indicates that the products might have been partially defrosted and refrozen at some point – temperature rises affect the quality of food.
- We recommend a temperature setting of 4°C for fresh food compartment and -20°C for freezer compartment to achieve better food preservation.
- With the exception of extreme conditions in ambient, if temperature is set to recommended values as +4°C/-20°C, overall freshness will be prolonged within fresh food and freezer compartments. If temperature of fresh food compartment is set to cooler, fresh fruits and vegetables may be partially frozen or exposed to cold injury, while warmer temperature level may cause faster spoilage of highly perishable foods (dairy products, meat products).



## Operation notes

### Disassembly and assembly method of accessory

--Glass shelf in the refrigerating chamber: the height of the shelf is adjustable, which facilitates the storage of articles with different volumes. Pull the shelf outwardly and upwardly in a slight way to take out.

--Fruit and vegetable box: for storing vegetables and fruits. It can be taken out by pulling outwardly.

--Drawer in the freezing chamber: storing foods to be preserved for long-term, such as meat and fish. It can be taken out by pulling outwardly and lifting upwardly.

Kindly tips: It is recommended to put into the large piece of meat after being cut into small pieces, to avoid difficult cutting after being frozen. The quick-freezing foods shall be distributed uniformly and stored together after being frozen.

--Bottle pedestal at the refrigerating door: storing eggs, various bottled drinks and other sundries. It can be taken out by being lifted up slightly.

Note: Don't pull out the bottle pedestal at the refrigerating door forcibly during disassembly, to avoid damaging the refrigerator.

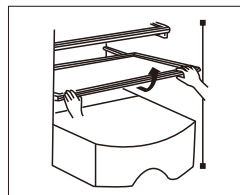

Take out by pulling upwardly and outwardly in a slight way

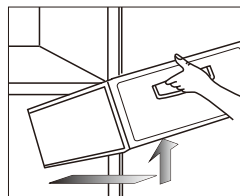

Take out by pulling outwardly and upwardly in a slight way

### Changing the Light

Any replacement or maintenance of the LED lamps is intended to be made by the manufacturer, its service agent or similar qualified person.

## Maintenance

It is suggested to maintain the refrigerator regularly ;

--Unplug the power plug to prevent from electric shock;

--Use wet cloth or neutral detergent (cleanser essence) to wipe off the oil contamination and other dirt. Then completely wipe off the detergent.

--Do not use alkaline detergent, soap powder, gasoline and alcohol, talcum powder etc.; otherwise the coats or plastics may be damaged;

--Regularly clean the refrigerator body and clear the ground dusts to keep the refrigerator clean.

Inspections after maintenance:

1. Whether there are damages to the power line and plug;
2. Whether there are dusts on the power plug;
3. Whether there is abnormal heat on the plug;
4. Whether the socket is loose;
5. Whether the plug is totally inserted.

#### Note:

If the power line and plug is damaged and there exist dusts, electric shock or fire may occur;

After unplugging the plug, 5 minutes must pass before re-plugging it;

Do not put your hands under the refrigerator to avoid getting hurt.

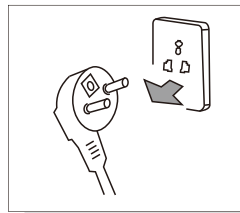

Unplug the refrigerator plug before cleaning



Please use neutral detergent

---

## **Failure analysis**

The following items shall be inspected before occurring failures which require maintenance:

### **Failures:Refrigerator does not work,The refrigeration effect is poor**

Causes:1. Check the connection of power supply. 2. Check whether the refrigerator is exposed to direct sunlight or whether there is heat source nearby. 3. Check whether there is heat dissipation space around refrigerator.

Remedies:1. Connect the power supply. 2. Move the refrigerator to a place without direct sunlight and heat source. 3. Leave sufficient space between refrigerator and wall.

### **Failures:Foods in refrigerating chamber are frozen**

Causes:1. Check whether the setting temperature is too low. 2. Check whether foods with too much water are too close to the rear wall.

Remedies:1. Adequately increase the temperature. 2. Move the foods with too much water to the door side of glass shelf

### **Failures:There is abnormal sound in refrigerator**

Causes:1. Check whether the bottom of refrigerator is stable. 2. Check whether the refrigerator is too close to the wall. 3. Check whether the refrigerator touches other objects.

Remedies:1. Adjust the bottom adjusting leg to stabilize the refrigerator. 2. Leave sufficient space around refrigerator. 3. Remove the obstacles.

### **Failures:There is abnormal odor in refrigerator**

Causes:1. Check whether the foods are sealed for storage. 2. Check whether the refrigerator is clean. 3. Check whether the foods are stored for too long time.

Remedies:1. Sealed foods for storage. 2. Regularly clean the refrigerator. 3.Do not store foods for too long time.

---

## **Non-failures**

### **Phenomenon:Warm or hot on two sides and spacing part surface between refrigerating chamber and freezing chamber.**

Cause:Refrigerator pipes (condenser, anti-fog pipes) are on two sides and front part of refrigerator for heat dissipation and to prevent from condensation.

### **Phenomenon:The door is too tight and not easy to open**

Cause:Reopening of the door immediately after closing it is hard because hot air enters the refrigerator and contracts to produce pressure difference. It is easy to open the door after a while.

### **Phenomenon:There is water ripple in refrigerator**

Cause:When starting or stopping the compressor, the refrigerant will make such sound; Water produced after defrosting will also make such sound.

### **Phenomenon:There is "Click" sound or tick sound in refrigerator**

Cause:Shrinkage and swelling of case will make such sound;When the case is cold or the door is opened, this sound will occur;

### **Phenomenon:There is hum sound in refrigerator**

Cause:Running of compressor will make such sound (if the refrigerator is not leveled, this sound will be louder)

### **Phenomenon:There is condensation or frosting freezing chamber door surface or food surface**

Cause:Temperature or humidity around the refrigerator is high;The door is opened for too long time;The foods with too much water are not sealed or tightly wrapped

### **Phenomenon:There is condensation on the built-in light surface**

Cause:Light will produce heat after being lit, and the door is opened for too long time. So there is temperature difference, and thus the light case will have condensation.

### **Phenomenon:There is condensation and water mist on body**

Cause:Humidity around refrigerator is high, and the moisture in the air will gather in the case to form condensation

## Technical parameter

|                               |                |  |  |  |  |  |
|-------------------------------|----------------|--|--|--|--|--|
| Model                         | MN13790PX      |  |  |  |  |  |
| Climate type                  | SN/N/ST/T      |  |  |  |  |  |
| Electric shock resistance     | I              |  |  |  |  |  |
| Star sign                     | ✱☆☆            |  |  |  |  |  |
| Total Storage Volume          | 442L           |  |  |  |  |  |
| Storage Volume of Fresh Food  | 300L           |  |  |  |  |  |
| Storage Volume of Freezer     | 142L           |  |  |  |  |  |
| Power type                    | 220-240V~/50Hz |  |  |  |  |  |
| Rated current                 | 1.95A          |  |  |  |  |  |
| Energy consumption E16        | 0.505 kWh/24h  |  |  |  |  |  |
| Energy consumption E32        | 1.314 kWh/24h  |  |  |  |  |  |
| Annual energy consumption AE  | 355 kWh/a      |  |  |  |  |  |
| Auxiliary energy consumption  | 22.790 kWh/a   |  |  |  |  |  |
| Lamp power                    | 3W             |  |  |  |  |  |
| Weight                        | 83kg           |  |  |  |  |  |
| Dimension                     | 703x677x1890   |  |  |  |  |  |
| Refrigerant and charge amount | R600a,68g      |  |  |  |  |  |
| Noise Volume                  | 40dB(A)        |  |  |  |  |  |

## Packing list

| Annex \ Model           | MN13790PX |  |  |  |  |  |
|-------------------------|-----------|--|--|--|--|--|
| Refrigerating shelf     | 3         |  |  |  |  |  |
| Fruit and vegetable box | 1         |  |  |  |  |  |
| Cover                   | 1         |  |  |  |  |  |
| Bottle bracket          | 6         |  |  |  |  |  |
| Ice-making box          | 1         |  |  |  |  |  |
| Egg box                 | 1         |  |  |  |  |  |
| Freezer upper drawer    | 1         |  |  |  |  |  |
| Freezer drawer          | 1         |  |  |  |  |  |
| Operating instruction   | 1         |  |  |  |  |  |

## Safe recovery instructions

### Disposal

Old appliances still have some surplus value. An environmentally friendly approach will ensure that valuable raw materials are recycled.

The refrigerants used in your equipment and insulation materials require special handling procedures. Make sure there is no pipe damage on the back of the equipment before handling. Up-to-date information on the options for disposing of old equipment and packaging from old equipment can be obtained from the local municipal office.

#### Correct Disposal of this product.



This marking indicates that this product should not be disposed with other household wastes throughout the EU. To prevent possible harm to the environment or human health from uncontrolled waste disposal, recycle it responsibly to promote the sustainable reuse of material resources. To return your used device, please use the return and collection systems or contact the retailer where the product was purchased. They can take this product for environmental safe recycling.

Table 1 Climate classes

| Class              | Symbol | Ambient temperature ranges°C |
|--------------------|--------|------------------------------|
| Extended temperate | SN     | + 10 to + 32                 |
| Temperate          | N      | + 16 to + 32                 |
| Subtropical        | ST     | + 16 to + 38                 |
| Tropical           | T      | + 16 to + 43                 |

Extended temperate: 'this refrigerating appliance is intended to be used at ambient temperatures ranging from 10 °C to 32 °C';

temperate: 'this refrigerating appliance is intended to be used at ambient temperatures ranging from 16 ° C to 32 ° C' ;

Subtropical: 'this refrigerating appliance is intended to be used at ambient temperatures ranging from 16 ° C to 38 ° C' ;

Tropical: 'this refrigerating appliance is intended to be used at ambient temperatures ranging from 16 ° C to 43 ° C' ;

### **Dear customer**

if you need customer service, please check warranty card for further information.

## BEKO UK AND IRELAND STANDARD MANUFACTURER GUARANTEE TERMS AND CONDITIONS

Your new Beko product is guaranteed against faulty materials, defective components or manufacturing defects.

**The standard guarantee starts from the date of original purchase of the product, and lasts for a period of twelve (12) months unless Beko plc (the "Manufacturer") agrees to extend the guarantee for the product in writing.**

**If you have purchased an American style Fridge freezer, the standard guarantee starts from the date of original purchase of the product, and lasts for a period of twenty-four (24) months unless Beko plc (the "Manufacturer") agrees to extend the guarantee for the product in writing.**

If you have any questions about the guarantee on your product (including how long it is valid), please contact your retailer or our contact centre on **0333 207 9710** (UK and Northern Ireland) or **01 862 3411** (Republic of Ireland)

This guarantee does not in any way diminish or affect your statutory rights in connection with the product. This guarantee is in addition to your statutory rights as a consumer. If you have any questions about these rights, please contact the retailer from which you purchased the product. In certain circumstances, it is possible that your statutory rights may offer additional or higher levels of protection than those offered under the terms of this guarantee.

### What is covered by this guarantee?

- Repairs to the product required as a result of faulty materials, defective components or manufacturing defects.
- Functional replacement parts to repair a product.
- The costs of a Beko Approved Engineer to carry out the repair.

### What is not covered?

- Transit and delivery damage.
- Cabinet or appearance parts, including but not limited to control knobs, flaps and handles.
- Accessories and/or consumable items including but not limited to ice trays, scrapers, cutlery baskets, filters and light bulbs.
- Repairs necessary as a direct or indirect result of:
  - Accidental damage, misuse or abuse of a product.
  - An attempted repair of a product by anyone other than a Beko Approved Engineer (the "Engineer").
  - Installation or use of a product where such installation or use fails to meet the requirements contained in this guarantee or the User Instructions Booklet.
- Repairs to a product operated at any time on commercial or non-residential household premises (unless we have previously agreed to the installation environment).

This guarantee is limited to the cost of repairing the product. To the extent permitted by law, the Manufacturer does not accept and will not be held liable for any financial loss incurred in connection with the failure of any product to operate in accordance with the expected standards. Such financial loss includes but is not limited to loss arising from:

- Time taken off work.
- Damaged food, clothing or other items.
- Meals taken at restaurants or from takeaways.
- General compensation for inconvenience.

### Important Notes

1. Your product is designed and built for domestic household use only.
2. The guarantee will automatically be void if the product is installed or is used in commercial or non-residential domestic household premises, unless we have previously agreed to the installation environment.
3. The product must be correctly installed, located and operated in accordance with the instructions contained in the User Instructions Booklet provided with your product.
4. Professional installation by a qualified Electrical Domestic Appliance Installer is recommended for all Washing Machines, Dishwashers and Electric Cookers (as incorrect installation may result in you having to pay for the cost of repairing the product).
5. Gas Cookers must be professionally installed by a Gas Safe (or Gas Networks Ireland for Republic of Ireland) registered gas installer.
6. This guarantee is given in respect of products purchased and used within the United Kingdom and the Republic of Ireland.
7. This guarantee is effective from the initial date of purchase of a new product from an authorised retailer and will be void if the product is resold.
8. This guarantee does not apply to graded sales (where the product is purchased as a "second").

9. Possession of a copy of these terms and conditions does not necessarily mean that a product has the benefit of this guarantee. If you have any questions, please call our Call Centre on the number set out above.
10. The Manufacturer reserves the right to terminate the guarantee if its staff or representatives are subjected to physical or verbal abuse in the course of carrying out their duties.
11. Optional extras, where available (i.e. extendable feet) are supplied on a chargeable basis only.

#### **Does Beko offer replacements?**

This is a repair-only guarantee. On occasion, the Manufacturer may at its sole discretion, replace your product with a new product instead of carrying out a repair. Where a replacement is offered, this would normally be an identical model but when this is not possible, a model of similar specification will be provided. The Manufacturer will cover the costs and arrange for the delivery of the new product and for the return of the old product. Any costs related to disconnecting the faulty product and installing the replacement product will not be borne by the Manufacturer unless previously agreed to in writing. The original guarantee will continue to apply to the replacement product; the new product will not come with a new guarantee.

#### **When will the repair take place?**

Our Engineers work Monday to Friday 9.00am to 5.00pm. Appointments outside these hours may be possible at the sole discretion of the Manufacturer but cannot be guaranteed. Whilst our Engineers will endeavour to minimize inconvenience and to meet requests for specific timed appointments, this cannot be guaranteed. We will not be liable for delays or if it is unable to carry out a repair because a convenient appointment cannot be arranged.

#### **Will there be any charge for the repairs?**

It is your responsibility to provide evidence to the Engineer that your product is covered by this guarantee with a proof of purchase. The Manufacturer reserves the right to charge for the reasonable cost of any service call if:

- You cannot provide evidence that your product is covered by this guarantee.
- Where a service call has been made and the engineer finds that there is no fault with your product.
- That your product has not been installed or operated in accordance with the User Instructions Booklet.
- That the fault was caused by something other than faulty materials, defective components or manufacturing defects.
- For missed appointments.

Payment of these costs are due immediately upon the Engineer providing you with an invoice. The Manufacturer reserves the right to terminate the guarantee if you fail to pay the costs for the service call in a timely manner.

If you are a resident of the United Kingdom, this guarantee will be governed by English law and subject to the English Courts, save where you live in another part of the United Kingdom, in which case the law and courts of that location will apply.

If you are resident in the Republic of Ireland, this guarantee will be governed by Irish law and the Irish courts will have jurisdiction.

This guarantee is provided by Beko plc. Beko House, 1 Greenhill Crescent, Watford, Hertfordshire. WD18 8QU.

Beko plc is registered in England and Wales with company registration number 02415578.

#### BEKO UK AND IRELAND BUILT-IN APPLIANCES GUARANTEE TERMS AND CONDITIONS

If you have purchased a built-in or integrated appliance, and registered it within 90 days of purchase by completing the online registration form, then the standard 12 month guarantee will be extended to 24 months, under the same terms and conditions as detailed in our Standard Guarantee Terms and Conditions.

## BEKO UK AND IRELAND PROSMART INVERTER MOTOR GUARANTEE TERMS AND CONDITIONS

**This 10 year guarantee relates to Beko products that feature the ProSmart Inverter Motor.**

The ProSmart Motor guarantee terms and conditions are in addition to our Standard guarantee terms and conditions detailed in the previous section.

**In order to activate the 10 year guarantee you MUST register the appliance within 90 days of the original purchase date. You can register by first visiting [Beko.co.uk/register](http://Beko.co.uk/register) and by following the online instructions.**

Beko Free standing appliances come with a 12 month parts and labour guarantee as standard,

Beko Built-in appliances come with a 12 month parts and labour guarantee as standard. This is extended to 24 months, free of charge, upon registration of the appliance. When you register your appliance for additional guarantee, you will automatically activate the ProSmart Motor 10 year guarantee. You do not need to register twice. ([beko.co.uk/guarantee-terms](http://beko.co.uk/guarantee-terms)).

To make a claim against your Beko ProSmart Inverter Motor Guarantee (the "Guarantee"), all customer and product details must be registered with Beko plc using the procedure outlined below.

1. This extra 9 years (for free standing appliances) or 8 years (for built-in or integrated appliances) guarantee is only effective after the expiration of the standard manufacturer's guarantee.
2. It is only valid for the ProSmart Inverter motors of selected washing machines, washer-dryers, tumble dryers and dishwashers. It does not cover any labour charge or any other components of the product. In addition, it is only valid for one replacement of the ProSmart motor during the extra 9-year (for free standing appliances) or 8 year (for built-in appliances) guarantee period.
3. To activate your guarantee, you MUST register your appliance within 90 days of the original purchase date, by visiting [beko.co.uk/register](http://beko.co.uk/register).
4. Customers will receive a unique reference code as proof of guarantee validation by email or post, which must be quoted at the time of a claim being made.
5. Any repair/replacement of the ProSmart Inverter motor must only be carried out by an authorised Beko Service Agent (the "Service Agent").
6. Labour for the repair/replacement of the ProSmart Inverter motor is not included in this guarantee and is chargeable directly by the Service Agent.
7. Any additional components fitted to the product at any time will not be covered by this guarantee and will be chargeable directly by the Service Agent.
8. The guarantee is not transferable and cannot be exchanged for cash.
9. There are no alternative or additional offers to this Guarantee.
10. The guarantee is exclusive of the manufacturer's standard guarantee
11. The Terms and Conditions shown above are in addition to the standard terms and conditions of your product guarantee. Please read and refer to such Terms and Conditions when making any claim.
12. We may use the information you provide for marketing purposes and to analyse your purchasing preferences. We may keep your information for a reasonable period for these purposes in accordance with the applicable Data Protection Laws and General Data Protection Regulations (GDPR). You can opt into this service during the registration process. Further details are available at <http://www.beko.co.uk/cookie-and-privacy>.
13. These Terms and Conditions are governed by the laws of England and Wales; manufacturer: Beko plc, Beko House, 1 Greenhill Crescent, Watford WD18 8QU. Company Registration Number: 02415578.



## HOW TO OBTAIN SERVICE FOR YOUR APPLIANCE

Please keep your purchase receipt or other proof of purchase details in a safe place; you will need to have this documentation available should the product require attention under guarantee.

Please take a few moments to complete the details below, as you will need this information when you call us, or to use our online services. When you call us you may be required to input your serial number into your telephone keypad. For help please visit [beko.co.uk/support/model-finder](http://beko.co.uk/support/model-finder)

- The product model number is printed on the Operating Instruction Booklet/ User guide
- The product model and serial number is printed on the Rating Label affixed to the appliance.
- The Retailer (Purchased from) and Date of purchase will be printed on your purchase receipt or other proof of purchase paperwork

Recording of these details alone will not count as proof of purchase. A valid proof of purchase is required for requesting service under guarantee.

| Model number | Serial number | Purchased from | Date of purchase |
|--------------|---------------|----------------|------------------|
|              |               |                |                  |

### For service under guarantee or for product advice please call our Contact centre

Before requesting service please check the troubleshooting guide in the Operating Instructions booklet, as a charge may be levied where no fault is found, and even though your product may still be under guarantee.

After arranging service the area around the product must be easily accessible to the Engineer, without the need for cabinets or furniture to be removed or moved.

It is your responsibility to ensure our Engineers have a clean and safe environment to carry out any repairs.

Please have your Model number and Serial number available when you call us, as you may be required to input your serial number into your telephone keypad during your call.

**UK Mainland & Northern Ireland:**

**0333 207 9710**

*Landline or mobile calls to 0333 numbers cost no more than calls to geographic numbers 01 or 02, and are charged at the basic rate. Calls from landlines and mobiles are included in free call packages but please check with your telephone service provider for exact call charges.*

**Republic of Ireland:**

**01 862 3411**

### Service once the manufacturers guarantee has expired

*If you have purchased an extended guarantee please refer to the instructions contained within the extended guarantee agreement document, otherwise please call us using the appropriate number above, where service can be obtained at a charge.*

Should you experience any difficulty in obtaining service please call us on **0333 207 9710** or **01 862 3411**

### Contact us through our website

Send us a secure message through our online contact us form. Please visit our website, click Contact Us and choose a product support topic from the list of options. Complete the required details and click send message.

### Product registrations

For UK registrations please visit [beko.co.uk/register](http://beko.co.uk/register) and for the Republic of Ireland visit [beko.ie/register](http://beko.ie/register).





